

U37771: Pod 5 Minerva Development



Vision:

Our vision for the site is to turn our pod into an area which will be aimed more towards multi generational families through the place making process in order to create a diverse and sustainable community.

Design Objectives:

- Sustainable - To create a community that is socially and environmentally sustainable
- Inclusive - To design the community in a way which is inclusive for people of all ages
- Safe - To structure streets in a way where they are safe for pedestrians, with high levels of surveillance
- Aesthetics - To design a scheme that is visually attractive with its own sense of character
- Accessible - To make the development accessible to all demographics of people, including those who may have a disability
- Economical - To create a scheme that is economically viable

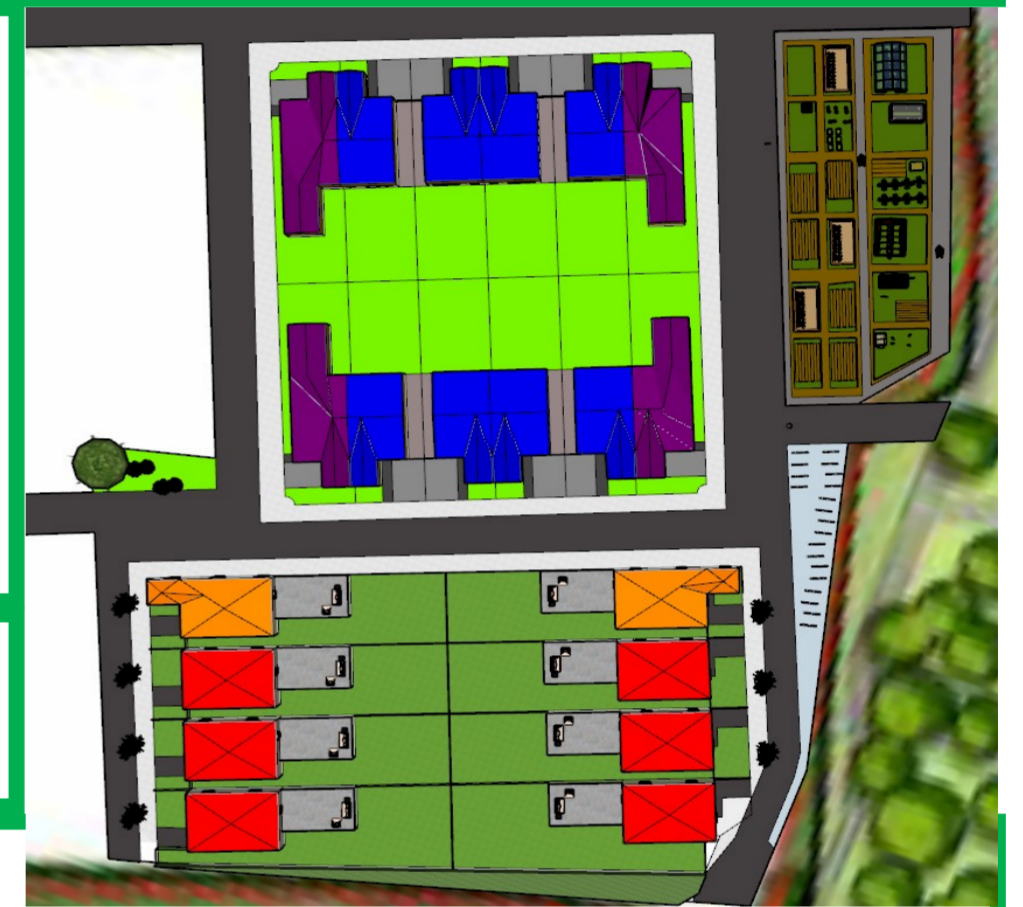

Community & Play Strategy:

Allotments

Due to our pod being expected to be composed of minimum 50% multi-generational household, which may include elderly family members we have decided to incorporate allotments into our scheme as it will provide community resources for members of the local community that might otherwise not be catered for. The allotments will increase the drainage of surface water while creating a carbon sink, thus making it a sustainable feature. It will be divided into smaller plots in order to enable a greater number of members of the community to participate.

Interactive Streets

The streets which run either side of the lower block lead into a dead end, this allows the streets to be used by children as there are few cars and any cars which travel down these roads will be travelling at a limited speed. Rather than having a green space as such, instead our design offers children from the houses along the street to come out and interact with each other.

Site Overview



Lower Block

Located to the south of the site, unique corner plots, block consist of 8 units. Well designed family homes, 2.5 story with the option of having a loft conversion in order to create an extra bedroom making the home expandable to addition children and investment.

Allotments

Upper Block

Located to the north of the site, surrounded on all sides by specially designed corner plots. The block has 12 units on it consisted of multi generational housing.

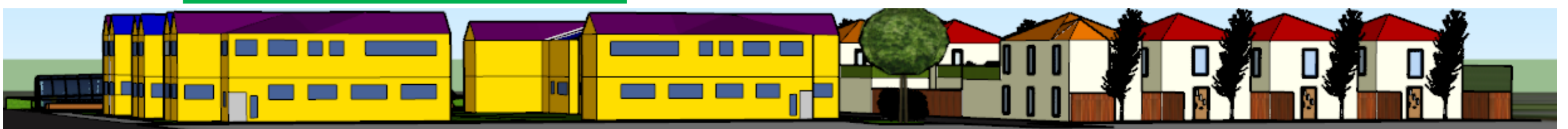

Matthew Chisnall
18074789@brookes.ac.uk



Theo Beckford
17074140@brookes.ac.uk